

**EVACUATION PLAN FOR GROUND FLOOR OF NEW BLOCK:**

All present on the ground floor of new block will assemble in old principal residence area via the following route in case of emergency declared:

**EXIT PLAN:**

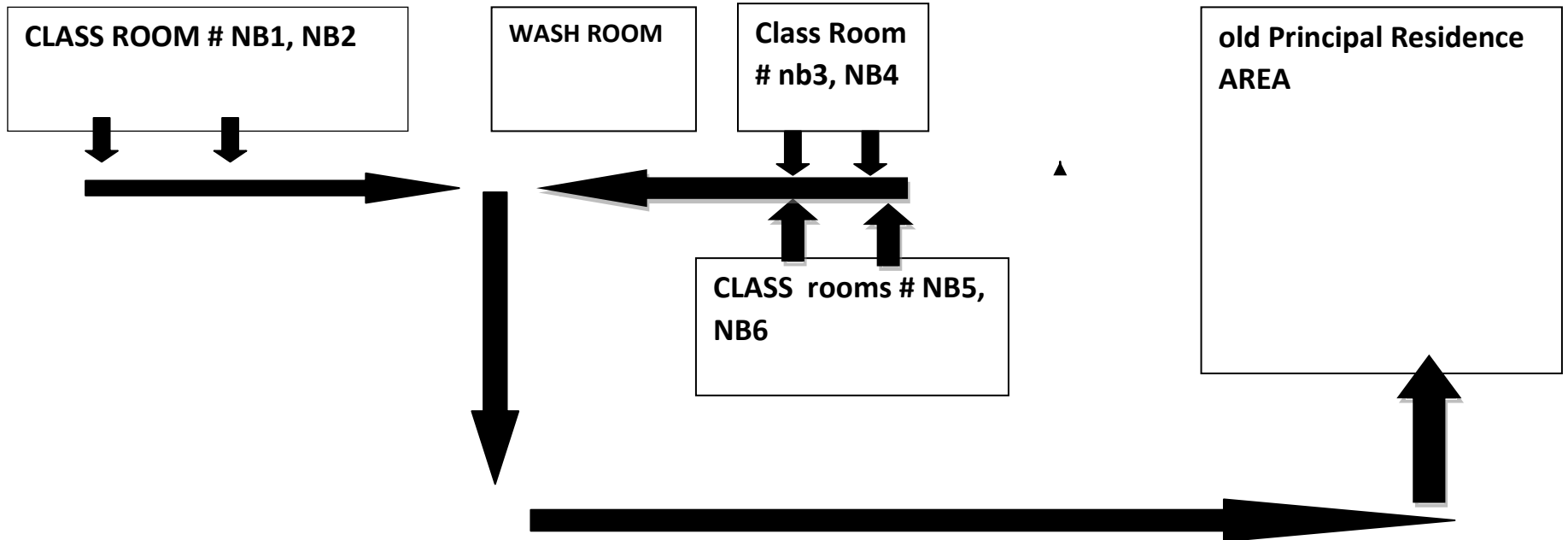

**EVACUATION PLAN FOR FIRST FLOOR OF NEW BLOCK:**

All present on the first floor of new block will assemble in old principal residence area via the following route in case of emergency declared:

**EXIT PLAN:**

